

Walk to school?

But how do I get to the front door?

WalkBoston works with communities across the Commonwealth

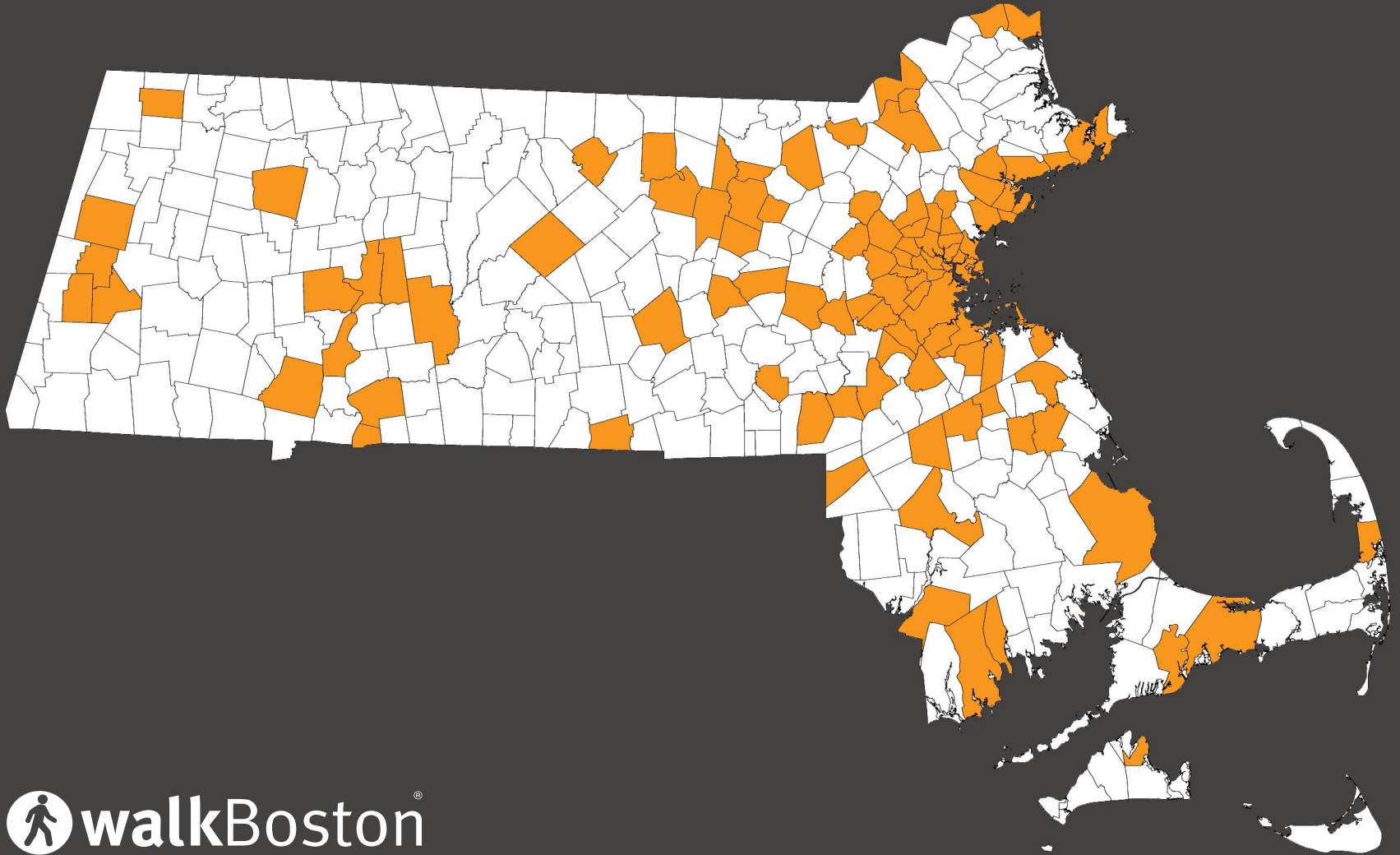



http://theforumnewsgroup.com/wp-content/uploads/2012/10/1018_p8_232-triple-parking_toned.jpg



What is a walkable campus?

Campus core as vehicle-free as possible Reduced parking

Pathway network Adequate shade Human scale Clear wayfinding

Pedestrian movement as primary mode of transportation

Memorable Ease of access **Safe** Places to wait Consistent paving materials

Defined routes Limited vehicular through traffic Clear points of entry

Parking on the periphery **Minimize conflicts with pedestrians and vehicles**

What is a walkable campus?

A **walkable** campus considers the needs of walkers first when organizing the movement of people, bicycles, cars, and buses on the school grounds.

Walkable campus design principles

- Safe streets
- Safe crossings
- Safe drop-off/pick-up
- Safe parking lots
- Safe front doors
- Safe spaces

Safe Streets



Source: MA SRTS

Safe Streets

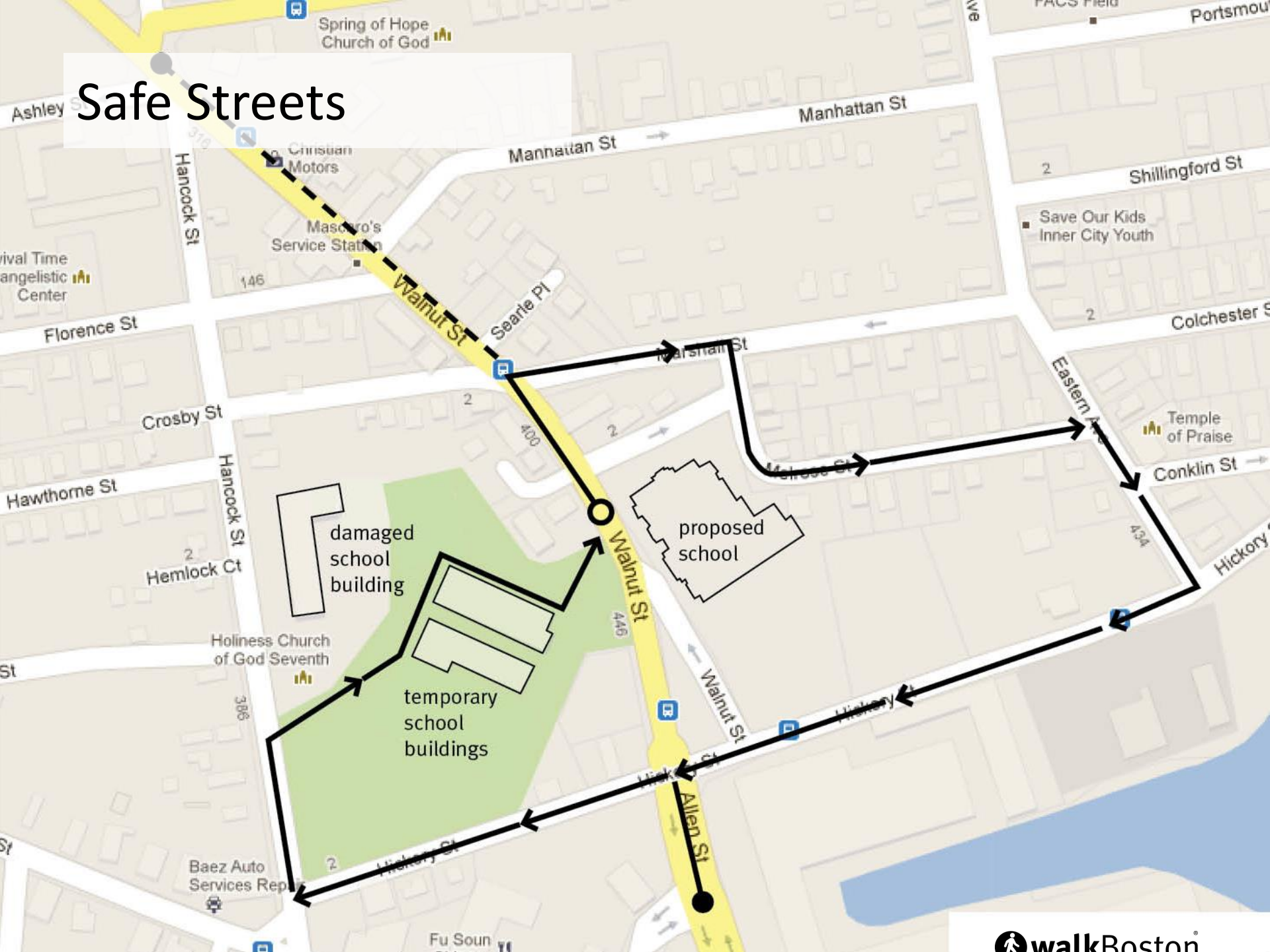

Safe Crossings



http://hyundaioregina.com/images/dealer_images/5/uploads/back-to-school-crossing-guard.jpg

Safe Crossings



<http://sf.streetsblog.org/wp-content/uploads/2010/11/raisedcrosswalk11.jpg>

Safe Drop-off Zones

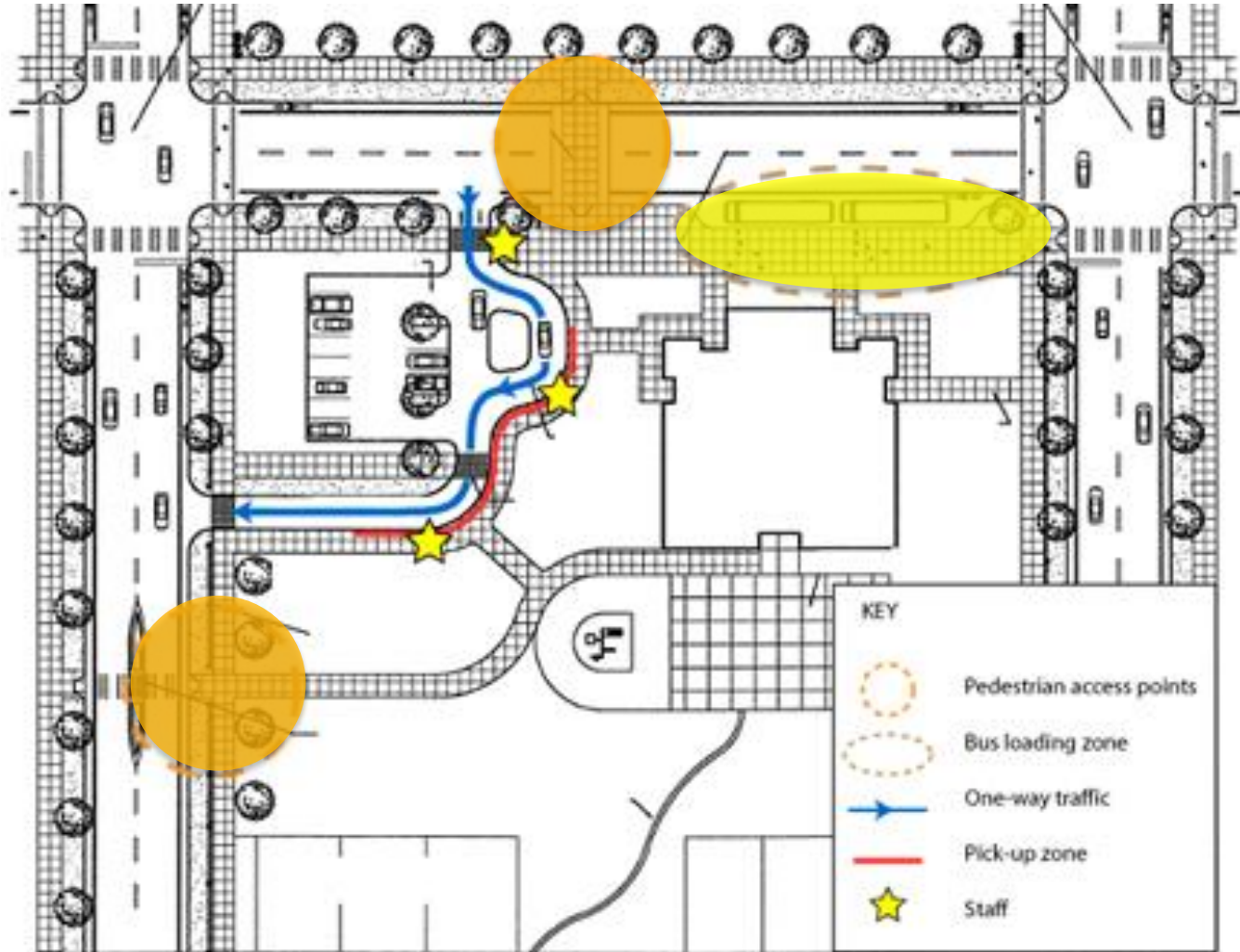

SCHOOL

good bye honey mommy loves you forever and ever and I will never stop loving you have a good day at school and I can't wait for you to come home!

Mom, chill, you're embarrassing me. I'm fifteen!!!

Here you go. Have fun today!

But we're not there yet. I can't walk all that way!!!

See ya. Bye.

Whoa, Dad, slow down! I'm not out of the car yet!!!

Safe Car Drop-off Zones



Safe Bus Drop-off Zones



Safe Parking Lots



Source: MA SRTS

Safe Parking Lots



Safe Front Doors



https://djc.com/stories/images/20110408/CherryCrestElementary_big.jpg



<http://www.nacarchitecture.com/images/projects/CherryCrestES-m.jpg>

Safe Spaces



end



Elias Brookings School Springfield, MA

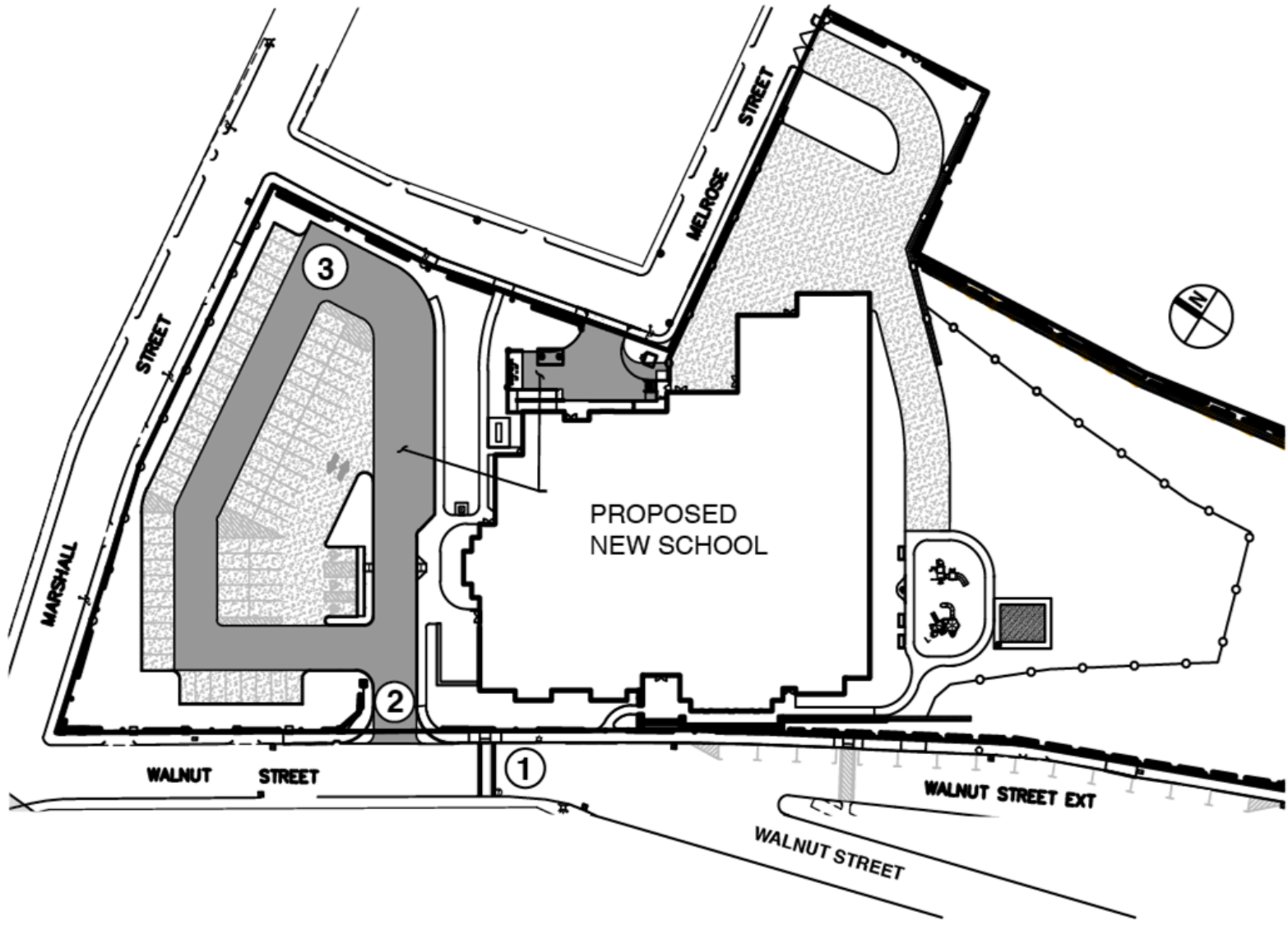

Proposed Brookings School Springfield, MA